



# MEETINGS & EVENTS

## 2019

---

# MEETINGS AT STOKE PARK

---

Stoke Park boasts 9 magnificent function rooms, all with glorious views across 300 acres of sweeping parkland estate.

Each room not only provides a professional, five star atmosphere for board meetings, training seminars and conferences, but has the added benefit of giving these events a breathtaking backdrop.

Stoke Park is one of the most awarded hotels in the UK, including being awarded 'Five AA Red Stars', which is the highest accolade given to hotels by the renowned guide series. Five Red Stars are awarded for outstanding facilities, service and all round customer experience.

For a full list of our awards and accolades, please visit our website [www.stokepark.com](http://www.stokepark.com)



# YOUR CHECKLIST...

## ✓ **LOCATION, LOCATION, LOCATION**

Only 35 minutes from Central London and 7 miles from London Heathrow, with easy access from the M4, M40 and M25 and close to both Slough and Gerrards Cross train stations.

## ✓ **FIVE STAR SERVICE**

Since 2013, we have held 5 AA Red Stars awarded for outstanding facilities, service and all round customer experience.

## ✓ **BREATHTAKING BACKDROP**

All of our private rooms not only provide a perfect atmosphere for your event, but have the added benefit of views across 300 acres of sweeping parkland.

## ✓ **FABULOUS FOOD**

Whether you are dining in a private room or in one of our three restaurants, rest assured that your dining experience will be exquisite thanks to our Head Chef Chris Wheeler. (Hotel Chef of the Year - Hotel Cateys 2016)

## ✓ **SOMETHING FOR EVERYONE**

World Class facilities including 27 hole championship golf course, state of the art gymnasium, fitness studio, 13 tennis courts, 11 treatment room spa , heated indoor pool, steam room, sauna, hot tub - there really is something for everyone!





## MEETINGS

### DAY DELEGATE

- Welcome Tea, Coffee and American Muffins
- Mid-morning Tea, Coffee and Home-made Biscuits
- Working Buffet\* or Two Course Luncheon
- Afternoon Tea, Coffee and Home-made Biscuits
- Room hire of main meeting room
- Half a litre of Mineral Water
- Confectionery
- Flip chart
- Stationery
- WiFi

*Day Delegate Rate - £125 per person*

### 24-HOUR DELEGATE

- Welcome Tea, Coffee and American Muffins
- Mid-morning Tea, Coffee and Home-made Biscuits
- Working Buffet\* or Two Course Luncheon
- Afternoon Tea, Coffee and Home-made Biscuits
- Room hire of main meeting room
- Half a litre of Mineral Water
- Confectionery
- Flip chart
- Stationery
- WiFi
- Three Course Table d'hôte Dinner
- Overnight luxury accommodation in a Mansion or Pavilion room
- Full English breakfast
- Full use of Pavilion leisure facilities

*24-Hour Delegate Rate - £430 per person*

\* Buffets are served for a minimum of 8 guests. Prices are exclusive of VAT and valid until 31st December 2019.

## PRIVATE DINING & CELEBRATIONS

All of our banqueting suites can be hired for private dining, whether you are a large group of 230 or an intimate party. Rest assured that with our dedicated service team and the finest of banqueting menus, not to mention our 9 beautiful suites, the event you hold will be magnificent. Should you need assistance with entertainment, theming, flowers or after-dinner speakers, let us step in to arrange it for you.

### Function Room Hire

|                   | Full Day | Half Day | Evening Hire |
|-------------------|----------|----------|--------------|
| The Repton        | £695     | £480     | £390         |
| The Chalfont      | £570     | £420     | £345         |
| The Park Salon    | £1880    | £999     | £650         |
| The Chapel        | £570     | £420     | N/A          |
| The Polo Lounge   | £675     | £480     | £390         |
| The Fountain Room | £1990    | £1189    | £850         |
| The Wyatt         | £685     | £470     | £370         |
| The Ballroom      | £1880    | £999     | £750         |
| The Buckingham    | £570     | £420     | £350         |

Prices are exclusive of VAT and valid until 31st December 2019.  
VAT is applied on rooms hired for Private Dining





## THE REPTON

An alcove of daylight and an exquisite fire-surround dominate this room, whilst original paintings and prints adorn the walls. The Repton will enhance any board meeting, private dining event or marriage ceremony.

|                   |                    |
|-------------------|--------------------|
| Dimensions        | 7.2m x 8.2m x 3.7m |
| Dining            | 27                 |
| Boardroom         | 18                 |
| Theatre Style     | 30                 |
| U-Shape           | 14                 |
| Cabaret           | 15                 |
| Drinks Reception  | 30                 |
| Voice Enhancement | No                 |
| Speakers          | No                 |
| TV Output         | Yes                |
| Open Fire         | Yes                |
| Natural Daylight  | Yes                |
| Double Socket     | 6                  |
| Telephone         | Yes                |

### Room Details:

- ★ Double Socket
- ✱ Gas Fire
- ☆ Single Socket
- Speakers
- ☎ Telephone
- ▶ TV Outlet
- ⊕ Voice Enhancement

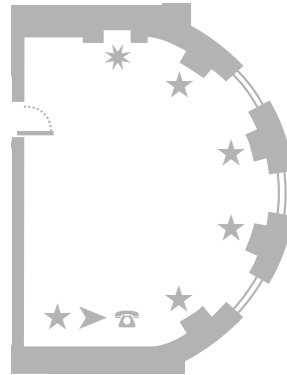

## THE CHALFONT

The Chalfont provides a light and airy venue for any meeting or private dining experience. Beautifully designed with Italian works of art and a touch of individuality this room will only serve to enhance your experience.

|                   |                    |
|-------------------|--------------------|
| Dimensions        | 3.6m x 6.4m x 3.7m |
| Dining            | 18                 |
| Boardroom         | 16                 |
| Theatre Style     | N/A                |
| U-Shape           | N/A                |
| Cabaret           | N/A                |
| Drinks Reception  | 20                 |
| Voice Enhancement | No                 |
| Speakers          | No                 |
| TV Output         | Yes                |
| Open Fire         | No                 |
| Natural Daylight  | Yes                |
| Double Socket     | 3                  |
| Telephone         | Yes                |

### Room Details:

- ★ Double Socket
- ✱ Gas Fire
- ☆ Single Socket
- Speakers
- ☎ Telephone
- ▶ TV Outlet
- ⊕ Voice Enhancement

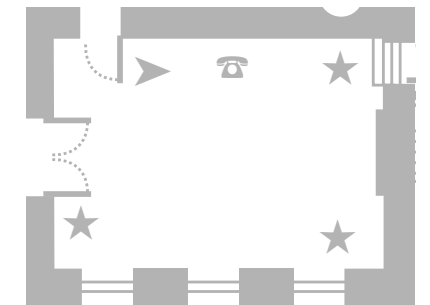



## THE PARK SALON

Located at the front of the Mansion with breathtaking views of the golf course, the Park Salon is an ideal setting for any event. By day, with its high specification audio-visual equipment to enhance any conference and by night, providing a wonderful atmosphere for a private dinner.

|                   |                 |
|-------------------|-----------------|
| Dimensions        | 7m x 12m x 3.5m |
| Dining            | 60              |
| Boardroom         | 24              |
| Theatre Style     | 100             |
| U-Shape           | 30              |
| Cabaret           | 40              |
| Drinks Reception  | 100             |
| Voice Enhancement | No              |
| Speakers          | Yes             |
| TV Output         | Yes             |
| Open Fire         | No              |
| Natural Daylight  | Yes             |
| Double Socket     | 8               |
| Telephone         | Yes             |

### Room Details:

- ★ Double Socket
- ✱ Gas Fire
- ☆ Single Socket
- Speakers
- ☎ Telephone
- ▶ TV Outlet
- 🗣 Voice Enhancement

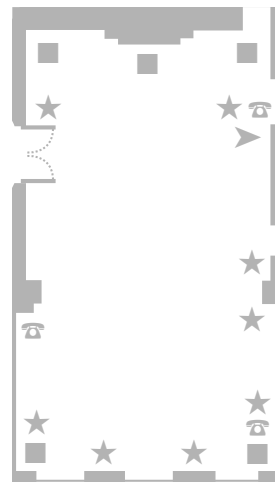

## THE CHAPEL

The original Chapel to the Penn family, this breathtaking example of Stoke Park's rich history boasts the most ornate carved panelling in all its glory and an open fire to welcome winter guests. The Chapel provides a spectacular setting for a small informal meeting and a dramatic backdrop for pre-dinner or after-dinner drinks.

|                   |                    |
|-------------------|--------------------|
| Dimensions        | 7.2m x 4.6m x 4.9m |
| Dining            | N/A                |
| Boardroom         | N/A                |
| Theatre Style     | N/A                |
| U-Shape           | N/A                |
| Cabaret           | N/A                |
| Drinks Reception  | N/A                |
| Voice Enhancement | No                 |
| Speakers          | No                 |
| TV Output         | No                 |
| Open Fire         | Yes                |
| Natural Daylight  | Yes                |
| Double Socket     | 5                  |
| Telephone         | Yes                |

### Room Details:

- ★ Double Socket
- ✱ Gas Fire
- ☆ Single Socket
- Speakers
- ☎ Telephone
- ▶ TV Outlet
- 🗣 Voice Enhancement

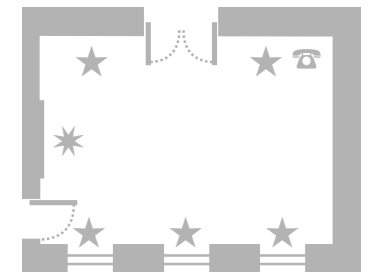

# THE POLO LOUNGE

Situated in the East Wing, this walnut wood lined room offers beautiful views of the golf course, gardens and historic church. An open fire serves to enhance the room's beauty through the winter months.

|                   |                  |
|-------------------|------------------|
| Dimensions        | 7m x 6.5m x 2.2m |
| Dining            | 18               |
| Boardroom         | 16               |
| Theatre Style     | 24               |
| U-Shape           | N/A              |
| Cabaret           | N/A              |
| Drinks Reception  | 20               |
| Voice Enhancement | No               |
| Speakers          | No               |
| TV Output         | Yes              |
| Open Fire         | Yes              |
| Natural Daylight  | Yes              |
| Double Socket     | 4                |
| Telephone         | Yes              |

## Room Details:

- ★ Double Socket
- ✱ Gas Fire
- ☆ Single Socket
- Speakers
- ☎ Telephone
- ▶ TV Outlet
- 🗣 Voice Enhancement

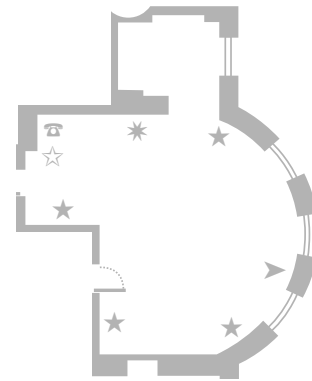

“BEST EVENT  
ORGANISED BY AN  
IN HOUSE TEAM”

EVCOM AWARDS

“BEST BUCKINGHAMSHIRE  
MEETING, CONFERENCE &  
EVENTS VENUE OF  
THE YEAR”

BUCKINGHAMSHIRE  
BUSINESS AWARDS



## THE FOUNTAIN ROOM

This spectacular south-facing room, overlooking the exquisite terrace, fountains and gardens, is without doubt one of the finest rooms in the country to enjoy a formal dinner or celebration. Surrounded by 200 years of history and elegant interior design, an event in the Fountain Room is an exceptional and memorable experience.

|                   |                     |
|-------------------|---------------------|
| Dimensions        | 7.5m x 24.5m x 4.9m |
| Dining            | 146                 |
| Boardroom         | 30                  |
| Theatre Style     | 70                  |
| U-Shape           | 24                  |
| Cabaret           | 40                  |
| Drinks Reception  | 160                 |
| Voice Enhancement | Yes                 |
| Speakers          | Yes                 |
| TV Output         | No                  |
| Open Fire         | 2                   |
| Natural Daylight  | Yes                 |
| Double Socket     | No                  |
| Telephone         | Yes                 |

### Room Details:

- ★ Double Socket
- ✱ Gas Fire
- ☆ Single Socket
- Speakers
- ☎ Telephone
- ▶ TV Outlet
- ⊕ Voice Enhancement

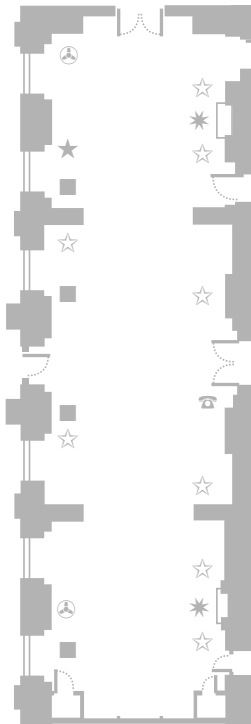

## THE BALLROOM

Situated in the West Wing, this elegant room offers magnificent high ceilings with the finest ornate mouldings and cornices. A breathtaking open fire is the focal point of this silk-panelled room, which offers exquisite views across the fountains and gardens landscaped by Humphry Repton and 'Capability' Brown.

|                   |                     |
|-------------------|---------------------|
| Dimensions        | 9.2m x 14.4m x 5.4m |
| Dining            | 72                  |
| Boardroom         | 34                  |
| Theatre Style     | 80                  |
| U-Shape           | 30                  |
| Cabaret           | 48                  |
| Drinks Reception  | 80                  |
| Voice Enhancement | Yes                 |
| Speakers          | Yes                 |
| TV Output         | Yes                 |
| Open Fire         | Yes                 |
| Natural Daylight  | Yes                 |
| Double Socket     | 8                   |
| Telephone         | Yes                 |

### Room Details:

- ★ Double Socket
- ✱ Gas Fire
- ☆ Single Socket
- Speakers
- ☎ Telephone
- ▶ TV Outlet
- ⊕ Voice Enhancement

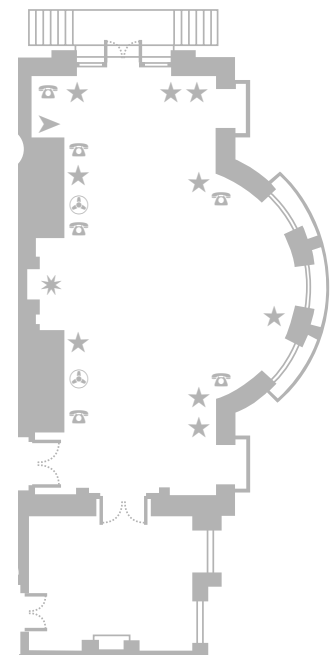





## THE BUCKINGHAM

A marble open fireplace and a spectacular tapestry enhance this room, whilst the grand chandelier brings life to the antique furnishings. The Buckingham is perfect for boardroom meetings and private dining events.

|                   |                    |
|-------------------|--------------------|
| Dimensions        | 6.6m x 6.5m x 3.9m |
| Dining            | 12                 |
| Boardroom         | 10                 |
| Theatre Style     | N/A                |
| U-Shape           | N/A                |
| Cabaret           | N/A                |
| Drinks Reception  | 20                 |
| Voice Enhancement | No                 |
| Speakers          | No                 |
| TV Output         | Yes                |
| Open Fire         | Yes                |
| Natural Daylight  | Yes                |
| Double Socket     | 3                  |
| Telephone         | Yes                |

### Room Details:

- ★ Double Socket
- ✳ Gas Fire
- ☆ Single Socket
- Speakers
- ☎ Telephone
- ▶ TV Outlet
- ⊕ Voice Enhancement

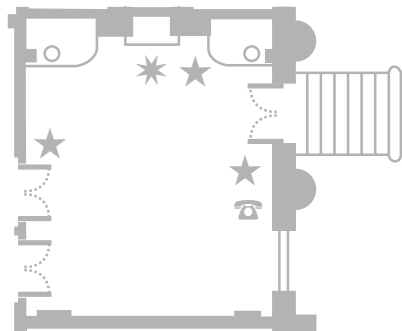

## THE WYATT

Lined with fine oil paintings and prints, The Wyatt, with its glass-domed ceiling (designed by James Wyatt) is as elegant as it is unique. The room has direct access to the beautiful South Terrace, where guests can enjoy refreshments whilst listening to the tranquil sounds of the Italian fountain.

|                   |                    |
|-------------------|--------------------|
| Dimensions        | 6.6m x 6.5m x 5.1m |
| Dining            | 24                 |
| Boardroom         | 16                 |
| Theatre Style     | 25                 |
| U-Shape           | N/A                |
| Cabaret           | N/A                |
| Drinks Reception  | 25                 |
| Voice Enhancement | No                 |
| Speakers          | No                 |
| TV Output         | Yes                |
| Open Fire         | No                 |
| Natural Daylight  | Yes                |
| Double Socket     | 6                  |
| Telephone         | Yes                |

### Room Details:

- ★ Double Socket
- ✳ Gas Fire
- ☆ Single Socket
- Speakers
- ☎ Telephone
- ▶ TV Outlet
- ⊕ Voice Enhancement

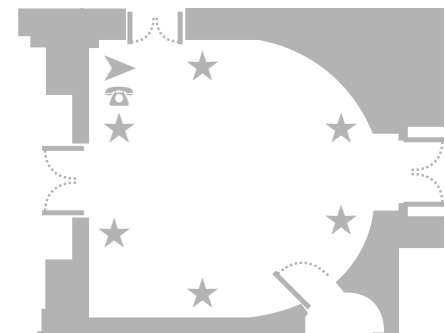

# ROOM CAPACITIES

| Room              | The Repton         | The Chalfont       | The Park Salon  | The Chapel         | The Polo Lounge  |
|-------------------|--------------------|--------------------|-----------------|--------------------|------------------|
| Dimensions        | 7.2m x 8.2m x 3.7m | 3.6m x 6.4m x 3.7m | 7m x 12m x 3.5m | 7.2m x 4.6m x 4.9m | 7m x 6.5m x 2.2m |
| Voice Enhancement | No                 | No                 | No              | No                 | No               |
| Speakers          | No                 | No                 | Yes             | No                 | No               |
| Dining            | 27                 | 18                 | 60              | N/A                | 18               |
| Boardroom         | 18                 | 16                 | 24              | N/A                | 16               |
| TV Output         | Yes                | Yes                | Yes             | No                 | Yes              |
| Theatre Style     | 30                 | N/A                | 100             | N/A                | 20               |
| Open Fire         | Yes                | No                 | No              | Yes                | Yes              |
| U-Shape           | 14                 | N/A                | 30              | N/A                | N/A              |
| Natural Daylight  | Yes                | Yes                | Yes             | Yes                | Yes              |
| Cabaret           | 15                 | N/A                | 40              | N/A                | N/A              |
| Double Socket     | 6                  | 3                  | 8               | 5                  | 4                |
| Drinks Reception  | 30                 | 20                 | 100             | N/A                | 20               |
| Telephone         | Yes                | Yes                | Yes             | Yes                | Yes              |

| Room              | The Fountain Room   | The Wyatt          | The Ballroom        | The Buckingham     |
|-------------------|---------------------|--------------------|---------------------|--------------------|
| Dimensions        | 7.5m x 24.5m x 4.9m | 6.6m x 6.5m x 5.1m | 9.2m x 14.4m x 5.4m | 6.6m x 6.5m x 3.9m |
| Voice Enhancement | Yes                 | No                 | Yes                 | No                 |
| Speakers          | Yes                 | No                 | No                  | No                 |
| Dining            | 146                 | 24                 | 72                  | 12                 |
| Boardroom         | 30                  | 16                 | 34                  | 10                 |
| TV Output         | No                  | Yes                | Yes                 | Yes                |
| Theatre Style     | 70                  | 25                 | 80                  | N/A                |
| Open Fire         | 2                   | No                 | Yes                 | Yes                |
| U-Shape           | 24                  | N/A                | 30                  | N/A                |
| Natural Daylight  | Yes                 | Yes                | Yes                 | Yes                |
| Cabaret           | 40                  | N/A                | 48                  | N/A                |
| Double Socket     | 1                   | 6                  | 8                   | 3                  |
| Drinks Reception  | 160                 | 25                 | 80                  | 20                 |
| Telephone         | Yes                 | Yes                | Yes                 | Yes                |

# MANSION FLOORPLAN



# THE BOODLES

Since 2002, The Boodles has attracted the world's tennis elite to play in the most exclusive, intimate and luxurious grass court tournament of the summer season. Set within our beautiful grounds, the tournament combines world class tennis with a quintessentially English summer garden party.

Year on year, The Boodles provides the perfect environment for the top male players to hone their skills in the build up to Wimbledon. Boris Becker, Goran Ivanisevic, Tim Henman, Andre Agassi, Rafael Nadal, Novak Djokovic, Alexander Zverev, Andy Murray and Juan Martin del Potro have all graced our Championship court and 2019 is set to feature even more icons of the game.

With an intimate crowd of 2,000 and no seat further than ten metres from the court, The Boodles gets you and your guests closer to the action than you ever thought possible.

We look forward to welcoming you to The Boodles from 25th June - 29th June 2019.

Please call 0207 384 4877 for further information or book online at [www.theboodles.com](http://www.theboodles.com)



## GOLF DAYS

Stoke Park's world renowned 27 hole Championship golf course provides a breath-taking backdrop for your corporate golf day.

By choosing Stoke Park as your venue, you and your guests are assured world class service, incredible golfing and an unforgettable experience.

We offer several different packages and corporate clinics, but can also put together a bespoke package to suit you. You can be sure that our team will make sure that your every need is catered for.

